

1. ASSEMBLE ITEM 1 TO COVER AS INDICATED BY CAPACITOR DISCHARGE WELDING.
2. ASSEMBLY MUST WITHSTAND MINIMUM 50# PULL TEST WITHOUT FAILURE OR DISTORTION.

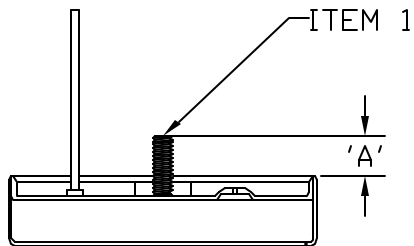
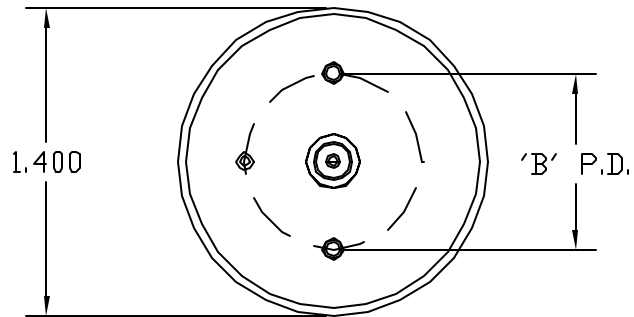

**MOUNTING INSTRUCTIONS**

THE PROPER MOUNTING STUD PRELOAD IS REACHED WHEN THE NUT IS TIGHTENED 1/2 TO 3/4 OF A TURN BEYOND THE POINT OF INITIAL CONTACT. THIS CORRESPONDS TO A TORQUE SETTING OF 24 - 28 INCH-OUNCES (1.5 TO 1.75 IN-LB), AND A STUD PRELOAD OF ABOUT 15 POUNDS IN TENSION.

WE DO NOT RECOMMEND LOCK WASHERS AS THEY INTERFERE WITH PROPER APPLICATION OF PRELOAD AND IN OUR TESTING, DID NOT GUARANTEE THE NUTS STAY TIGHT DURING VIBRATION EXPOSURE. USE AN ADHESIVE THREAD LOCKER THAT CONFORMS TO MIL-S-22473E, GRADE A - RED.

SUFFIX	ITEM 1 DESCRIPTION	'A'	'B'	
SM	0410-SM	0.22	0.800	2-56 THD
SM01	0410-SM01	0.2B	0.800	2-56 THD
SM02	0410-SM02	0.41	0.800	2-56 THD
SM03	0410-SM03	0.16	0.800	2-56 THD
SM04	0410-SM04	0.19	0.800	2-56 THD

2	SEE TABLE	1	
REQ'D	PART/CONTROL NO.	DESCRIPTION	ITEM
TOLERANCES(UNLESS NOTED)			
X.XXX = +/- 0.010	DATE	REV.	COMMENTS
X.XX = +/- 0.020	1/17/08	E	CHANGED PER ECO
	7/9/09	H	ADDED MOUNTING NOTES
	1/7/09	G	CHANGED ITEM1 DESCRIPTION IN CHART
	4/7/06	F	MODIFIED DIMENSION 'A' IN TABLE
DIMENSIONS ARE IN INCHES			
MATERIAL:			
EVANS CAPACITOR COMPANY 72 BOYD AVE. EAST PROVIDENCE, RI			
THQ1/3/5 STUD MOUNTING			
DRAWN BY: DAVE EVANS	SIZE A	DATE 10/24/05	DWG NO. THQ-101
APPROVED BY:	SCALE	EGG ©2005	REV H
			SHEET 1 OF 1